

# KANDO 85

AvA Yachts



## SPECIFICATION

Location:	TURKEY
Yacht type:	MOTOR
Lenght:	85' (25.70 Meters)
Beam:	25' 7" (7.5 Meters)
Draft:	7' 4" (2.3 Meters)
Engines:	2x Volvo Penta D13-MH 450 HP
Number of cabins:	4
Number of guests:	8
Number of crew:	3
Year:	Summer 2025

## DESCRIPTION

### ABOUT KANDO85

Kando85 is a 25.7 meters new-build Explorer yacht, scheduled for delivery in 2025. Constructed by AvA Yachts in Turkey, Kando85 is designed as a full displacement world cruiser, capable of enduring long voyages and extended periods at sea.

# KANDO 85

AvA Yachts



Her robust build includes a steel hull and an aluminium superstructure. The Kando85 features a four stateroom layout with a main deck forward master suite, offering spacious accommodation within her 200 GT volume.

Kando85's aft deck is equipped with a spacious swimming platform, built-in seating around a dining table, while the salon includes a lounge and a dining area. Forward to starboard, there is a day head and the full beam main deck master suite with panoramic windows, a desk, and a bathroom. The enclosed galley is accessible from the port side.

A staircase from the main lobby leads to lower deck, which houses two crew cabins, a head, and a crew mess/galley. The main accommodation area on board Kando85 includes a full beam VIP cabin, and two twin cabins to starboard and port side that can convert to a double.

The upper deck features a centerline helm in the wheelhouse, built-in seating on both sides, and a day head aft to port. Outside, there is a bar with three bar stools, a davit, and ample spaces for an owner-supplied tender. A gently sloped stainless ladder connects to the aft deck. The foredeck area includes a Jacuzzi, ideal for relaxation. The Kando85's flybridge is equipped with a sunbathing area, a grill, a bar, and spacious seating.

Powered by twin Volvo Penta engines, Kando85 achieves a cruising speed of 7-9 knots and a top speed of 11 knots, with a range of 6700 nautical miles at 8 knots. Kando85 is built with 8-10mm thick underwater steel and multiple watertight bulkheads, ensuring ultimate safety.

## KEY FEATURES

- New-build Explorer yacht with delivery in summer 2025
- Steel hull and aluminum superstructure
- Master suite on main deck
- Range of 6700 nautical miles at 8 knot
- Jacuzzi on the foredeck
- Enhanced safety with 8-10mm underwater steel thickness and multiple watertight bulkheads

KANDO 85

AvA Yachts



PROFILE

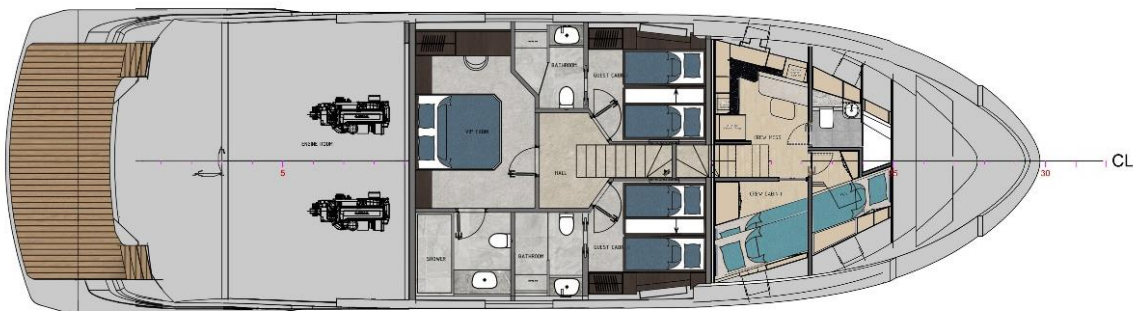

LOWER DECK PLAN



MAIN DECK PLAN



UPPER DECK PLAN

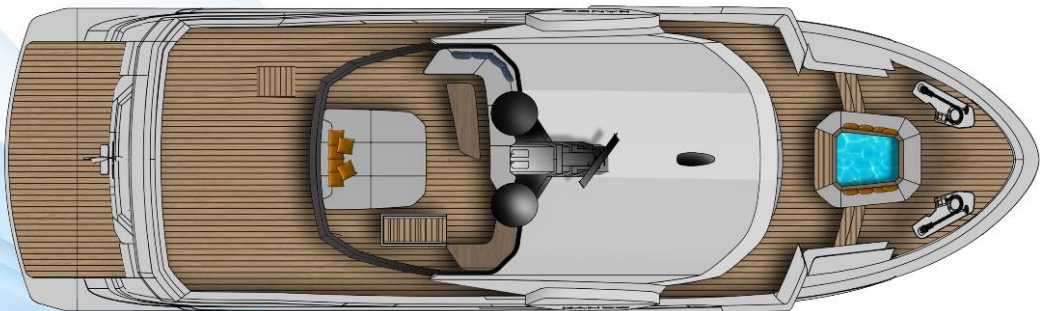

FLY BRIDGE PLAN



**KANDO 85**  
AvA Yachts





# KANDO 85

AvA Yachts



AvA Yachts





**KANDO 85**  
AvA Yachts





**KANDO 85**  
AvA Yachts





**KANDO 85**  
AvA Yachts





**KANDO 85**  
AvA Yachts





KANDO 85

AvA Yachts





**KANDO 85**  
AvA Yachts





**KANDO 85**  
AvA Yachts







AvA Yachts

[sales@avayachts.com](mailto:sales@avayachts.com)  
[avayachts.com](http://avayachts.com)

CONFIDENTIAL

This document includes confidential proprietary data belonging to AvA Yachts, and all rights regarding the same are expressly reserved. It is submitted under a confidential relationship for the specific purpose of evaluating the construction of the referenced Yacht by the Client. The Client and the Client's advisers, by accepting this document, assume custody and control and agree that it will not be reproduced in whole or in part, nor its contents revealed in any manner or to any person except to meet the purpose for which it was intended and subject to the relevant confidentiality warnings.