

KANDO 110 – HULL III

AvA Yachts



SPECIFICATION

Location:	TURKEY
Yacht type:	MOTOR
Length:	110' 3" (33.60 Meters)
Beam:	25' 7" (7.80 Meters)
Draft:	7' 4" (2.5 Meters)
Engines:	2x650 HP Volvo Penta
Number of cabins:	6
Number of guests:	12
Number of crew:	5
Year:	January 2026

DESCRIPTION

ABOUT KANDO110

Kando110 is a 33.6 meters new-build Explorer yacht, scheduled for delivery in 2026. Constructed by AvA Yachts in Turkey, Kando110 is designed as a full displacement world cruiser, capable of enduring long voyages and extended periods at sea.

KANDO 110

AvA Yachts



Her robust build includes a steel hull and an aluminium superstructure. The Kando110 features a six stateroom layout with a main deck forward master suite, offering spacious accommodation within her 320 GT volume.

Kando110's aft deck is equipped with a spacious swimming platform, built-in seating around a dining table, while the salon includes a lounge and a dining area. Forward to starboard, there is a day head and the full beam main deck master suite with panoramic windows, an owner office, dressing room and a bathroom. The enclosed galley is accessible from the port side.

A staircase from the main lobby leads to lower deck, which houses five cabins. The main accommodation area on board Kando110 includes a VIP cabin on forward and four double guest cabins on sides.

The upper deck features an upper deck salon with seating area and bar area, a day head with bathroom for captain on starboard, a comfortable and useful cabin for the captain on portside, and a centerline helm in the separated wheelhouse. Outside, there is a chaise longue area for sunbathing. The foredeck area includes an ample space for an owner-supplied tender with the crane. The Kando110's flybridge is equipped with a sunbathing area, a grill, a bar, spacious seating, and a Jacuzzi, ideal for relaxation.

Powered by twin Volvo Penta engines, Kando110 achieves a cruising speed of 9 knots and a top speed of 14 knots, with a range of 6400 nautical miles at 9 knots. Kando110 is built with 8-10mm thick underwater steel and multiple watertight bulkheads, ensuring ultimate safety.

KEY FEATURES

- New-build Explorer yacht with delivery in January 2026
- Steel hull and aluminum superstructure
- Master suite on main deck
- Range of 6400+ nautical miles at 9 knot
- Jacuzzi on the flybridge
- Enhanced safety with 8-10mm underwater steel thickness and multiple watertight bulkheads

KANDO 110

AvA Yachts



AvA Yachts



PROFILE



LOWER DECK



MAIN DECK



UPPER DECK

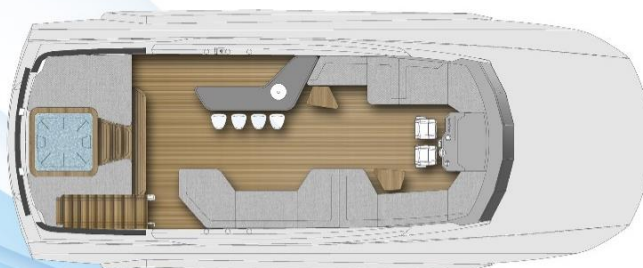

FLYBRIDGE DECK

KANDO 110

AvA Yachts



KANDO 110

AvA Yachts



KANDO 110
AvA Yachts



KANDO 110
AvA Yachts



KANDO 110
AvA Yachts



KANDO 110
AvA Yachts



KANDO 110
AvA Yachts



KANDO 110

AvA Yachts



AvA Yachts



KANDO 110

AvA Yachts



KANDO 110
AvA Yachts



KANDO 110
AvA Yachts



KANDO 110
AvA Yachts



KANDO 110

AvA Yachts



KANDO 110
AvA Yachts



KANDO 110
AvA Yachts





KANDO 110
AvA Yachts



KANDO 110

AvA Yachts



KANDO 110

AvA Yachts



KANDO 110

AvA Yachts



KANDO 110

AvA Yachts



AvA Yachts

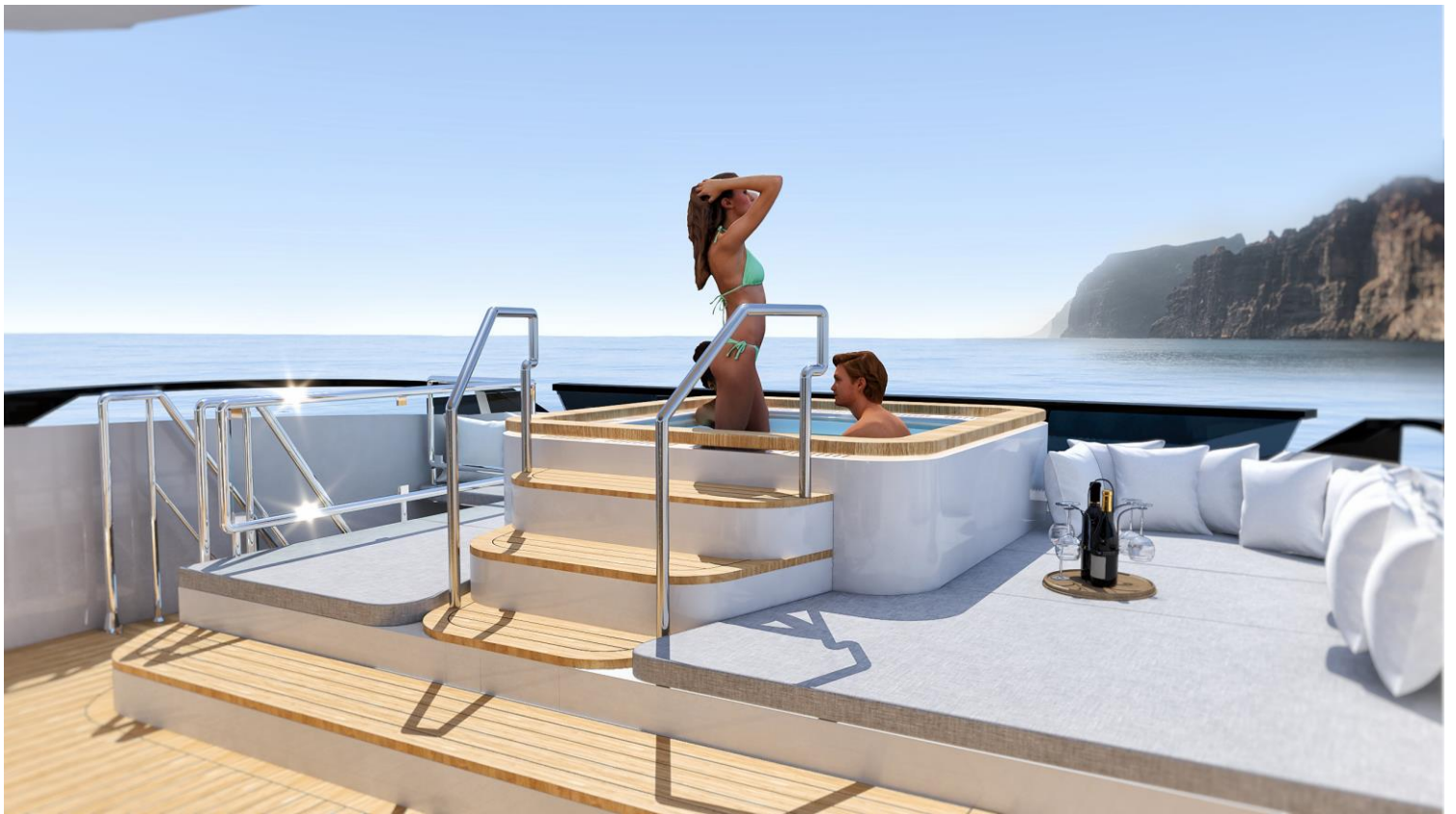



AvA Yachts

sales@avayachts.com
avayachts.com

CONFIDENTIAL

This document includes confidential proprietary data belonging to AvA Yachts, and all rights regarding the same are expressly reserved. It is submitted under a confidential relationship for the specific purpose of evaluating the construction of the referenced Yacht by the Client. The Client and the Client's advisers, by accepting this document, assume custody and control and agree that it will not be reproduced in whole or in part, nor its contents revealed in any manner or to any person except to meet the purpose for which it was intended and subject to the relevant confidentiality warnings.